

Prestan® AED UltraTrainer™



PRESTAN®

Prestan AED UltraTrainer™

Model PP-AEDUT-101 → **Prestan AED UltraTrainer** preprogrammed with English/Spanish language, 3 'C' batteries (pre-installed), one set of adult/child training pads (pre-installed), one set of extra connector pins and a nylon carrying case.



Model PP-AEDUT-401 → **Prestan AED UltraTrainer 4-Pack** preprogrammed with English/Spanish language, 12 'C' batteries (pre-installed), four sets of adult/child training pads, four sets of extra connector pins, 4 single nylon cases and a 4-pack nylon carrying case.



START HERE

- Use this instruction sheet as a reference for the Prestan AED UltraTrainer and Accessories.
- **Warning:** The Prestan AED UltraTrainer is intended for training purposes only. It is **NOT** an Automated External Defibrillator (AED) and will not deliver a shock. To avoid confusion, it should **NEVER** be kept in the same area with AEDs.
- Owner's information – For future reference, make note on your Quick Start Card of the Prestan Authorized Distributor where you purchased your AED Trainer and keep it with your unit. Contact your Prestan Authorized Distributor for product questions, reordering parts/accessories, or warranty issues.
- For information on Prestan's Authorized Distributors, help guides, resources and more, please visit the Prestan website at www.prestanproducts.com.

Features of the Prestan AED UltraTrainer

- High Performance Training Pads
 - ⇒ Clear Anatomical Placement Graphics
 - ⇒ Long-Life Adhesive
 - ⇒ Adheres well to all Manikins with no messy residue left behind
 - ⇒ Unique Pad Connector with locking Connector Pin
- Pad Sensing System
 - ⇒ Pads are pre-connected
 - ⇒ Pads on-manikin detection
 - ⇒ Remote Control NOT Required
 - ⇒ Plugging in connector NOT Required
 - ⇒ Works on any Manikin
- Protective & Reusable Pad Tray
- Adult / Child Selection Button
- Bright Illuminated Shock Button
 - ⇒ Flashes when shock is advised
- On/Off Button with Lighted Indicator and Program Pause Option
- Five Training Scenarios
- Clear & Calm Voice Prompts
- Chest Compression Rate Metronome
 - ⇒ Metronome can be turned on or off
 - ⇒ Metronome audible count reminders at 10, 20 and 30 compressions
- Automatic OR Semi-Automatic Shock-Delivery
- Programming Option to either include or not include time for breaths after compression cycle
- Long Battery Life
 - ⇒ Low Battery Voice Prompt Warning
 - ⇒ Automatic Shut Off Extends Battery Life
- Water & Splash Resistant
- Programming is compliant with current AHA Guidelines (2015)

ADULT/CHILD TRAINING PADS

- Pad cords are pre-connected to the AED Trainer
- Pad Sensing System automatically lets the unit know when the pads have been connected to a manikin
- Pads last for 100+ uses
- Unique pad replacement (see assembly section)
- Pads are stored on a convenient double-sided Pad Tray



Prestan AED UltraTrainer™



FEATURE GUIDE

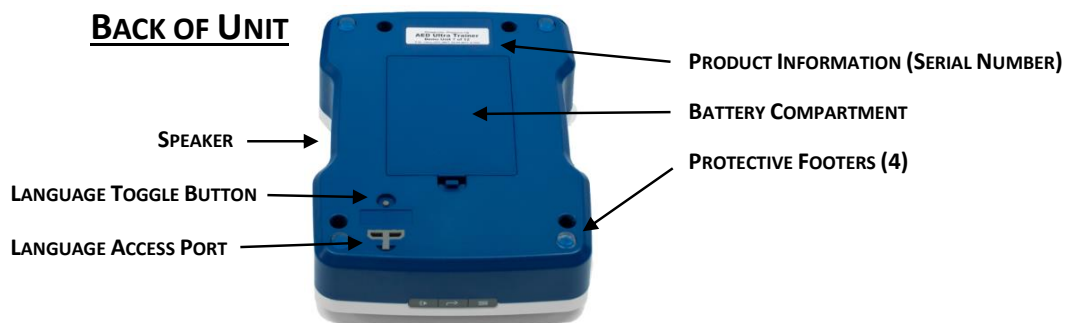

ACTION BUTTONS

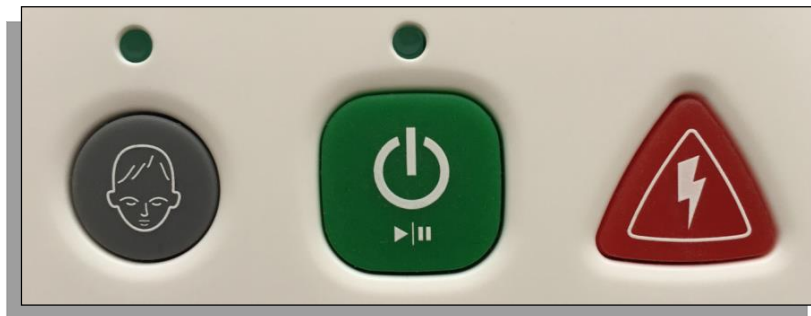

Child Button

On/Off/Pause Button

Shock Button

CHILD BUTTON

- After power is turned on, the programming offers an audible option to select the Child Button
- Indicator light above the Child Button will light up when the Child option has been selected and is active
- Indicator light turns off if the program is paused, but turns back on when the program is resumed

ON / OFF / PAUSE BUTTON

1. Push green button to start program / the indicator light above the button will turn on
2. Push green button again to pause program / indicator light will blink / push green button again to resume program
3. When unit is running, push and hold the button for 3 seconds to shut off unit

SHOCK BUTTON

- Red Shock Button will flash when program instructs to deliver shock
- In Semi-Automatic mode, pushing the Shock Button while it is flashing will stop the flashing and resume the program
- In Automatic mode, the Shock Button will flash approximately 6 times before auto-shocking and resuming the program.

OPTION BUTTONS

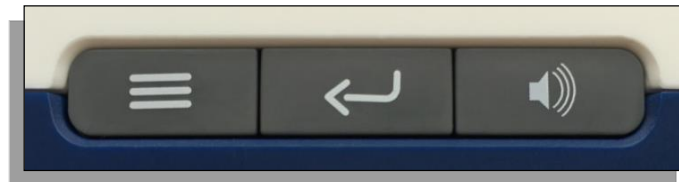

Menu Button

Selection Button

Volume Button

MENU BUTTON

The Menu Button allows customization of 4 options and can be used at any time. Push the Menu Button repeatedly to scroll through and hear each selection currently active for each of the options (see 1-4 below). Use the Selection Button to scroll through and change these options.

SELECTION BUTTON

Use with the Menu Button to change settings for each of the 4 Menu options. Repeatedly press Selection Button to hear current selection and scroll to the next. After you hear the option desired, simply stop pressing the button and that selection will remain active. A beep will be heard to confirm selection is set.

1. Available Training Scenarios:
 - a. Scenario 1 > Shock / Shock / Shock (default)
 - b. Scenario 2 > Shock / No Shock / No Shock
 - c. Scenario 3 > No Shock / No Shock / No Shock
 - d. Scenario 4 > Shock / No Shock / Shock
 - e. Scenario 5 > Shock / Shock / No Shock
2. Semi-Automatic / Automatic toggle
 - a. Semi-Automatic > Student must push flashing Shock Button to deliver shock (default)
 - b. Automatic > Unit will deliver shock when Shock Button is lit
3. Ventilations toggle
 - a. Ventilations On > Time is provided in scenarios to give breaths (default)
 - b. Ventilations Off > No time is provided in scenarios to give breaths
4. Metronome toggle
 - a. Metronome On > Audible ticks are heard for compression rhythm (default)
 - b. Metronome Off > No ticks are heard during compression section of program

See chart on Page 7 for Ventilations / Metronome interaction.

VOLUME BUTTON

- Toggle the Volume Button between 3 volume levels
- Works independently of Menu and Selections Buttons

FEATURE SETTINGS

	Ventilations On	Ventilations Off
CPR Metronome On	<ol style="list-style-type: none"> 1. Program begins with analyzing patient and advising shock or no shock based on user scenario setting. 2. Audible prompt “BEGIN CPR” starts compression cycle. 3. Metronome beats and audible prompt notes “TEN”, TWENTY, and THIRTY compression counts. 4. After 30 compression beats, the metronome pauses for an audible prompt to “GIVE 2 BREATHS”. 5. Compressions beats and breaths continue for 5 cycles (2 minutes). 6. Unit analyzes patient. 7. Cycles repeat indefinitely following scenario shock pattern until unit is manually shut off. 	<ol style="list-style-type: none"> 1. Program begins with analyzing patient and advising shock or no shock based on user scenario setting. 2. Audible prompt “BEGIN CPR” starts compression cycle. 3. Compression beats with audible prompt to “CONTINUE CPR” every 24 seconds (x4). 4. Compression beats continue for 2 minutes. 5. Unit analyzes patient. 6. Cycles repeat indefinitely following scenario shock pattern until unit is manually shut off.
CPR Metronome Off	<ol style="list-style-type: none"> 1. Program begins with analyzing patient and advising shock or no shock based on user scenario setting. 2. Audible prompt “BEGIN CPR” starts compression cycle. 3. Audible prompt notes “TEN”, TWENTY, and THIRTY compression counts. 4. After time for 30 compressions, the metronome pauses for an audible prompt to “GIVE 2 BREATHS”. 5. Compressions beats and breaths continue for 5 cycles (2 minutes). 6. Unit analyzes patient. 7. Cycles repeat indefinitely following scenario shock pattern until unit is manually shut off. 	<ol style="list-style-type: none"> 1. Program begins with analyzing patient and advising shock or no shock based on user scenario setting. 2. Audible prompt “BEGIN CPR” starts compression cycle. 3. Silence except for audible prompt to “CONTINUE CPR” every 24 seconds (x4). 4. Cycle stops at 2 minutes. 5. Unit analyzes patient. 6. Cycles repeat indefinitely following scenario shock pattern until unit is manually shut off.

CARE AND CLEANING INSTRUCTIONS

1. Store the Prestan AED UltraTrainer in its case and in a cool, dry area.
2. Return the training pads and cables to their respective storage pouches located on the interior lid of the unit's cover. If pads and cables are stacked on top of the unit, the cables may imprint grooves/indentations into the surface of the pads.
3. Starter batteries have been installed for immediate use of the unit. Starter batteries should be replaced with quality alkaline batteries within a month of purchase. If the unit is being stored for long periods, remove batteries to protect against corrosion.
4. Never pick up or carry the unit by the cables.
5. The Prestan AED UltraTrainer should be kept clean. If it becomes soiled, simply wipe with a clean, damp, soft cloth. If the Trainer is extremely dirty, common cleaners can be used cautiously with a minimum amount of abrasion to ensure the life of the unit. Do not submerge unit in water.

PAD REPLACEMENT

1. Prestan Training Pads will generally last approximately 100 uses.
2. When pad replacement is needed, it is good practice to replace both pads at the same time.
3. Release the existing pads from the gray cable connectors by popping out the black pad connector pins with the tip of a ball point pen.
4. Slide the pads out from the cable connectors.
5. Insert new pads into the cable connectors.
6. Use the pad connector pins to lock the pads in place.

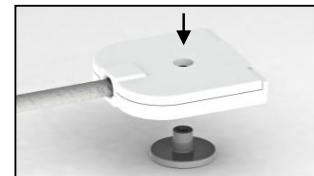

- Insert pad into cable connector (be sure the pad graphics are on same side as the large head of the connector pin and that the connector pin snugly fits into the indentation in the cable connector)

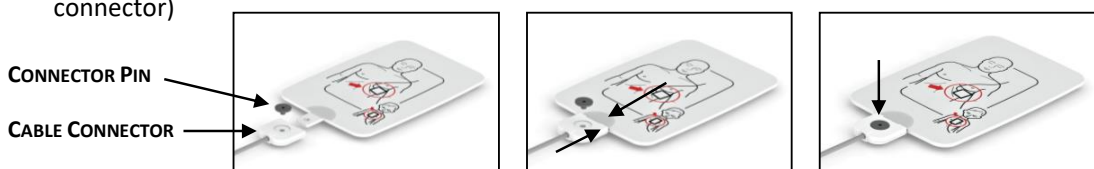

- Insure pad is not upside down
- If the pad has a protective backing over the adhesive (replacement pads), remove and dispose of this and adhere the pads to the double-sided pad case

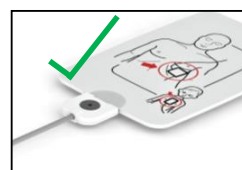

TROUBLESHOOTING GUIDE

SYMPTOM	POSSIBLE ISSUES OR COMMENTS	SOLUTIONS
Unit does not turn on	<ul style="list-style-type: none"> Unit must be manually turned on Batteries are not property installed Batteries are dead or are missing 	<ul style="list-style-type: none"> Push green power button Re-orient batteries properly Replace batteries
Both pads attached to manikin but device will not advance to analysis	<ul style="list-style-type: none"> Operational solution Pad is inserted upside down in the cable connector Pad or Adhesive worn out 	<ul style="list-style-type: none"> Insure pads are pressed on firmly, specifically so that the sensor in the center of the adhesive is touching a surface Push out black connector pin, flip pad around and re-secure with black connector pin Replace pad (lasts 100+ uses)
Device proceeds to analyzing before both pads have been placed on the manikin	<ul style="list-style-type: none"> Pads not properly positioned on tray Look for pad riding up pad tray wall 	<ul style="list-style-type: none"> Re-position pad on tray to lay completely flat so it is not touching side walls
Device delivers shock before shock button is pressed	<ul style="list-style-type: none"> Device is In Automatic mode 	<ul style="list-style-type: none"> Change back to Semi-Automatic Mode
Device prompts "Replace Batteries"	<ul style="list-style-type: none"> Device will run 10 or more hours with low batteries 	<ul style="list-style-type: none"> Replace batteries within 10 hours
Device suddenly shuts down or voice prompts are distorted	<ul style="list-style-type: none"> Batteries are very low, almost dead 	<ul style="list-style-type: none"> Install new batteries
Pad pulls out from pad connector	<ul style="list-style-type: none"> Check for black connector pin missing 	<ul style="list-style-type: none"> Install new black connector pin
Pad will not stick to the manikin	<ul style="list-style-type: none"> Adhesive is worn out 	<ul style="list-style-type: none"> Replace pads (lasts 100+ uses)
Grooves/indentations are appearing on the surface of the pads	<ul style="list-style-type: none"> The cables are indenting into the surface of the pads from improper storage placement 	<ul style="list-style-type: none"> Store cables and pads in their respective pouches in the interior lid of the unit's carry bag

WARRANTY

Three Year Limited Warranty

1. **WARRANTY COVERAGE.** Prestan (The Manufacturer) offers a LIMITED WARRANTY against any defects in workmanship or materials under normal use with respect to its PRESTAN AED ULTRATRAINER.
2. **WARRANTY PERIOD.** Prestan warrants the PRESTAN AED ULTRATRAINER for three (3) years from the date of purchase. Any component of the PRESTAN AED ULTRATRAINER which proves defective within thirty-six (36) months from the date of purchase will be repaired or replaced (at Prestan's option), free of charge to the owner. The owner is responsible for shipping and handling fees to the place which Prestan designates.
3. **WARRANTOR'S RESPONSIBILITIES.** Prestan will repair or replace (at Prestan's option) a defective warranted component subject to the provisions of Section 2 without charge except for transportation costs. OWNER'S SOLE AND EXCLUSIVE REMEDY AGAINST PRESTAN SHALL BE FOR THE REPAIR OR REPLACEMENT OF DEFECTIVE GOOS AS PROVIDED HEREIN. Repair or replacement of any component of any PRESTAN AED ULTRATRAINER does not extend this limited warranty or begin a new limited warranty period.
4. **CIRCUMSTANCE NEGATING WARRANTY AND OTHER LIMITATIONS.**
 - a. Prestan reserves the right to refuse warranty service or replacement when product failure is due to misuse, mishandling, misapplication, accident, neglect, improper installation, modification, use of unauthorized parts or attachments, adjustments or repair performed by anyone other than Prestan or its authorized agent, or any causes other than defective workmanship or material.
 - b. This limited warranty does not cover abrasion, abnormal use, damage caused by mishandling, neglect or unauthorized modification. This warranty is void if the PRESTAN AED ULTRATRAINER is structurally altered.
 - c. This warranty does not cover consumable items such as batteries that may be provided as a courtesy or training pads used beyond their indicated limit.
 - d. Owner must provide proof of the date of purchase, place of purchase and the purchase price in order to obtain service under this limited warranty.
 - e. Prestan makes no warranty other than as contained herein. No agent, representative, dealer or employee of Prestan has the authority to alter the obligations or limitations of this limited warranty.
5. **LIMITATIONS OF IMPLIED WARRANTIES AND DAMAGES**
 - a. Any and all implied warranties on the PRESTAN AED ULTRATRAINER, INCLUDING ANY IMPLIED WARRANTY OF MERCHANTABILITY OR FITNESS FOR A PARTICULAR PURPOSE, SHALL NOT EXCEED IN DURATION THE RESPECTIVE TERMS OF THIS LIMITED WARRANTY WHICH BEGIN WITH THE DATE OF PURCHASE. Some states do not allow limitations on how long an implied warranty lasts, so the above limitation may not apply to you.
 - b. PRESTAN SHALL NOT BE LIABLE FOR INCIDENTAL OR CONSEQUENTIAL DAMAGES ARISING OUT OF THE USE OF THE PRESTAN AED ULTRATRAINER OR THE BREACH OF THIS OR ANY OTHER EXPRESSED OR IMPLIED WARRANTY. Some states do not allow the exclusion or limitation of incidental or consequential damages, so the above limitation or exclusion may not apply to you. Any and all damages awarded for any breach of this limited warranty shall be limited to the amount of the purchase price.
6. **WARRANTY SERVICE.** To obtain warranty service contact your Prestan Authorized Distributor, or for information about Prestan, visit our website at www.prestanproducts.com.
7. **RIGHTS UNDER STATE LAW.** This warranty gives you specific legal rights and you may have other rights which vary from state to state.

PARTS & ACCESSORIES

Contact your Prestan Authorized Distributor for Pricing and Ordering



11678
Single Carry Bag for the AED UltraTrainer



11806
4-Pack Carry Bag for the AED UltraTrainer

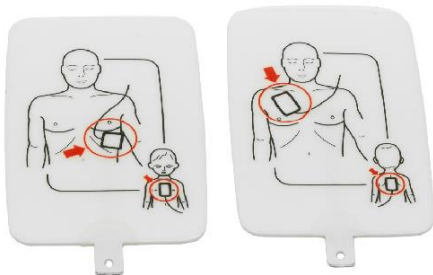

PP-UTPAD-1
Single set of Adult/Child Training Pads
for the AED UltraTrainer

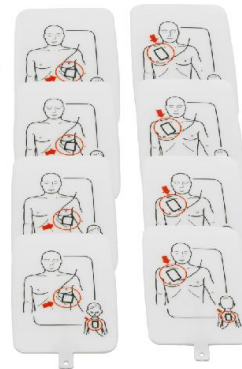

PP-UTPAD-4
Four (4) sets of Adult/Child Training Pads
for the AED UltraTrainer



RPP-AEDUT-CABLE
Replacement Cable Assembly for
the AED UltraTrainer



RPP-AEDUT-TRAY
Replacement Pad Storage Tray
for the AED UltraTrainer



PP-AEDUT-101-D English/Spanish
PP-AEDUT-102-D English/French
Language dongle for
the AED UltraTrainer

The Prestan AED UltraTrainer™

offers features not found on any other universal AED trainer.

This compact and lightweight unit gives students a realistic training experience with training pads that sense when they are placed on a manikin. In addition, the pads are preconnected and voice prompts are clear and calm.

Instructors can customize their training class with options to turn on or off the compression metronome and/or ventilation voice prompt.

With a 3-year warranty and durable long-lasting pads, the AED UltraTrainer is built to last.

Prestan is the First and Only Universal AED Trainer with:

- ✓ Dual Graphic (Adult/Child) Training Pads
- ✓ Pad Sensing System
- ✓ Preconnected Pads
- ✓ Child Training Button
- ✓ Child AED specific voice prompts
- ✓ Automatic or Semi-Automatic shock simulation
- ✓ CPR Coaching, "Give Breaths" voice prompt
- ✓ Turn on or off compression metronome
- ✓ Turn on or off "Give Breaths" prompts
- ✓ Low Battery warning
- ✓ 3 Year Warranty

Other features:

- ✓ Two languages (English, Spanish)
- ✓ 2015 Guidelines Compliant and Upgradable
- ✓ Play/Pause Button
- ✓ 5 Training Scenarios



Learn more about the Prestan AED UltraTrainer™
Scan the QR Code to watch the video

Prestan Products LLC © 2017



PRESTAN®

www.prestanproducts.com